

ROB WOLFE
MANAGING DIRECTOR
SOCIAL VALUE CONSULTANT

CHY CONSULTANCY



BIO

Rob has worked in physical and social regeneration at a front line and strategic level for 20 years and went on to set up CHY in 2006. Partnership working, and social value are at the heart of his experience and expertise: ensuring projects and people achieve the combined objectives of all sectors, while benefiting the communities they serve. Rob's influence within the construction industry and its stakeholders was reflected when CHY won 8 Constructing Excellence Awards for its collaborative approach and Rob himself won the National Achiever of the Year in 2011.

Rob has gone on to influence local, regional and national social value policy; assisting local authorities to maximise the socio-economic impact of their local plans and the private sector to embed, deliver and measure the socio-economic impact of their projects, products and services.

Rob believes in radical collaboration; bringing innovation, expertise and best practice from across different sectors to benefit the built environment, their clients and the communities in which they work.

WHY CHOSEN

- 15+ years' specific experience of creating, delivering and measuring Social Value in the built environment
- Expertise in the design, development and delivery of employment, skills and supply chain initiatives in the built environment
- In depth knowledge of national, regional and local social value policy and inclusive economic growth
- In depth knowledge of apprenticeships, training and skills development in the built environment
- Expertise in sustainable employment, job creation and employability
- Expertise in cross sector collaborative working between the public, private and third sectors.



Fellow of the Royal Society of Arts (FRSA)

Constructing Excellence
Procurement Theme Group
& Social Value Task Group –
Chair

Constructing Excellence
Regional Board Member

Social Value UK Member

SOME KEY PROJECTS

Project Name: West 12 (2017-ongoing)

Description: Strategic, planning, policy and social value research at pre-planning stage for major regeneration (residential, retail and leisure) scheme in west London.

Role: Social Value and Strategic Research

Client: Land Securities

Project Value: TBC

Project Name: Be First London & Southern Construction Framework (2018)

Description: Pre-tender Social Value and Employment and Skills Design, Development and Delivery for a tender submission for the Be First London and Southern Construction Framework. (successful)

Role: Social Value and Employment and Skills Design, Development and Delivery

Client: McLaren Construction

Project Value: £6.2 billion

Project Name: Extra MSA Leeds Skelton Lake

Description; Major Motorway Service Area retail, leisure and commercial development

Role: Planning support. Social Value and Employment and Skills Design, Development and Delivery.

Client: Extra MSA

Project Value: £60 million

Project Name; Leeds Housing Regeneration Project (PFI) (2013-2016)

Description; Major housing refurbishment and new build social housing development

Role: Social Value and Employment and Skills Design, Development and Delivery

Client: Leeds City Council/Keepmoat

Project Value: £350 million

Project Name; Leeds Arena (2011-2013)

Description: Major city centre leisure development

Role: First independent facilitation of Social Value and Employment and Skills Design, Development and Delivery embedded from procurement through delivery to operation.

Client: Leeds City Council/BAM Construction

Project Value: £60 million

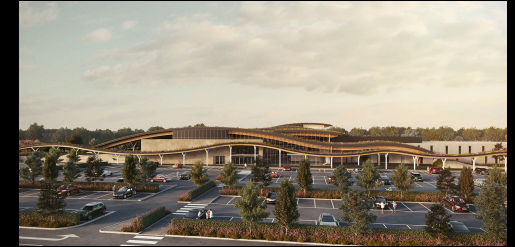

ROB WOLFE FRSA

07377 388 502

www.ch-y.co.uk

rob.wolfe@ch-y.co.uk

